



Asking Rent:

\$12.50 PSF

30,217 SF

1680 Vimont Court, Unit 103 | Ottawa, ON

Industrial / Warehouse Space For Lease

- High-bay industrial / warehouse space in the Taylor Creek Business Park
- 30,217 SF unit available for lease including a small showroom and second floor office
- The space features 5 dock-level doors (2 double-width) and 7 dock positions in total, all with levelers

Specifications

Building Area	30,217 SF
Office Space	Approx. 2,500 SF
Loading	5 dock-level doors (2 double-width) 7 dock positions in total
Ceiling Height	28' clear
Parking	Ample
Zoning	IL4 - Light Industrial
Asking Rent	\$12.50 PSF
Additional Rent	Estimated \$5.83 (includes utilities)

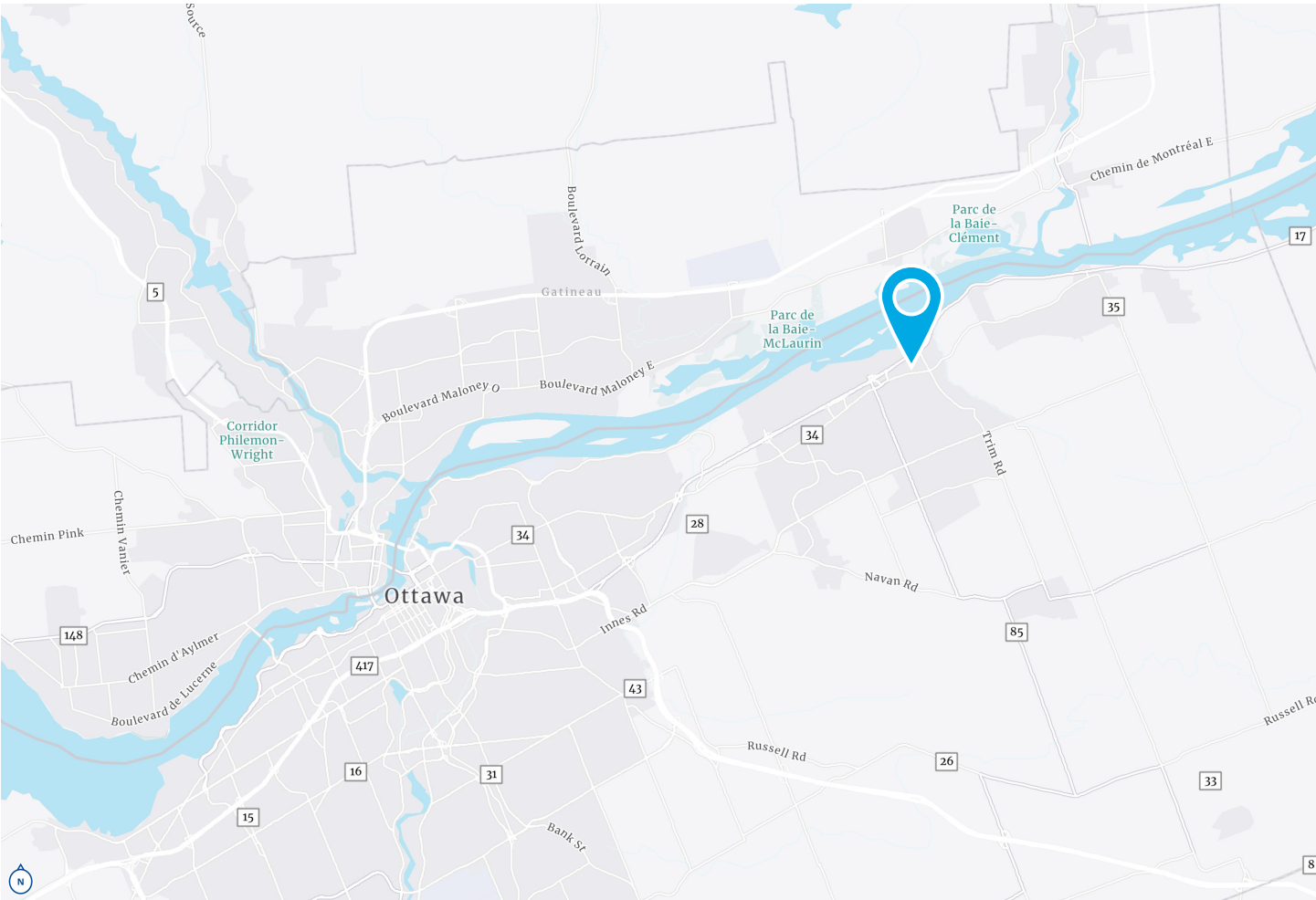

Building Plan

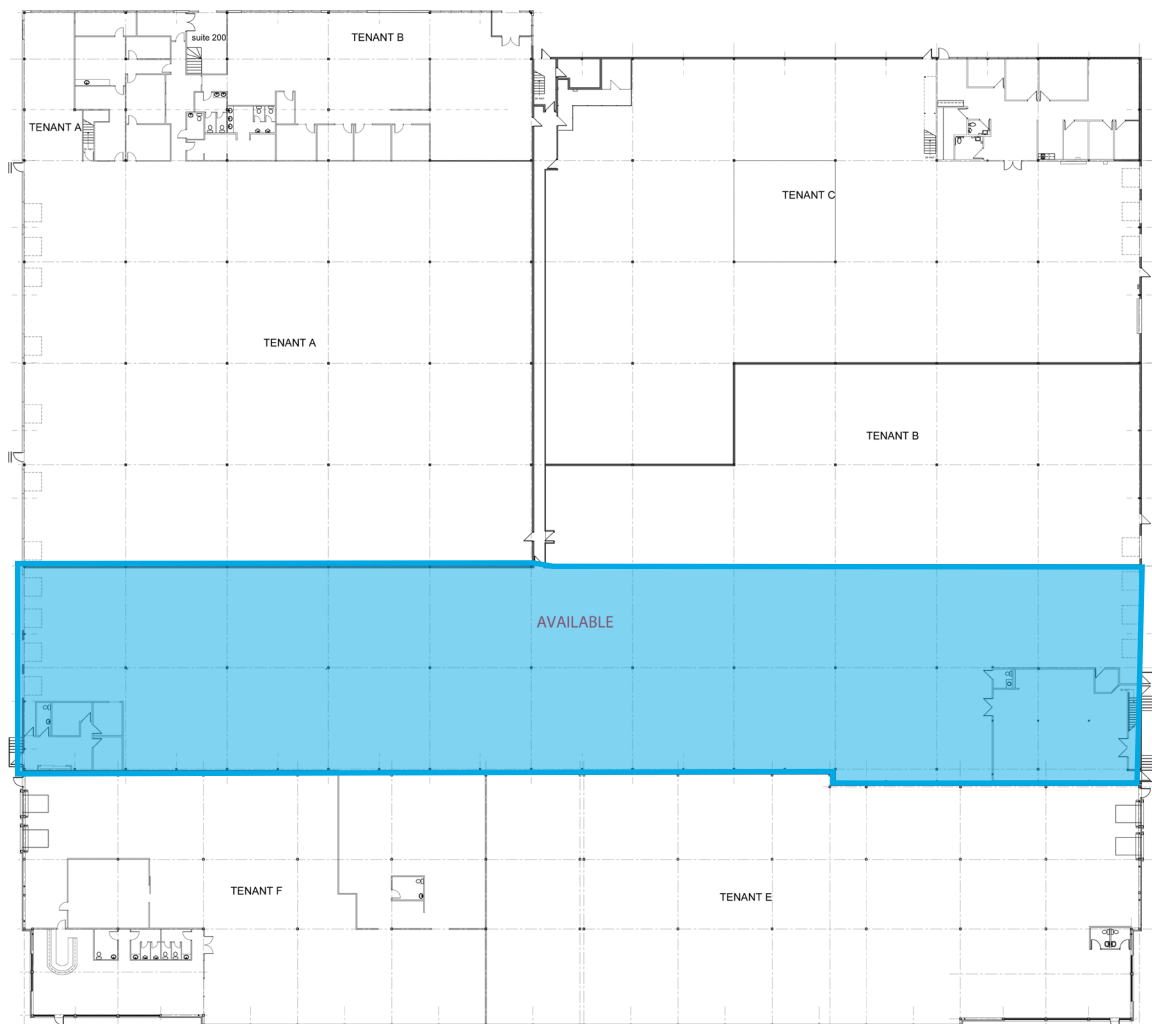

Proposed Demising Plan

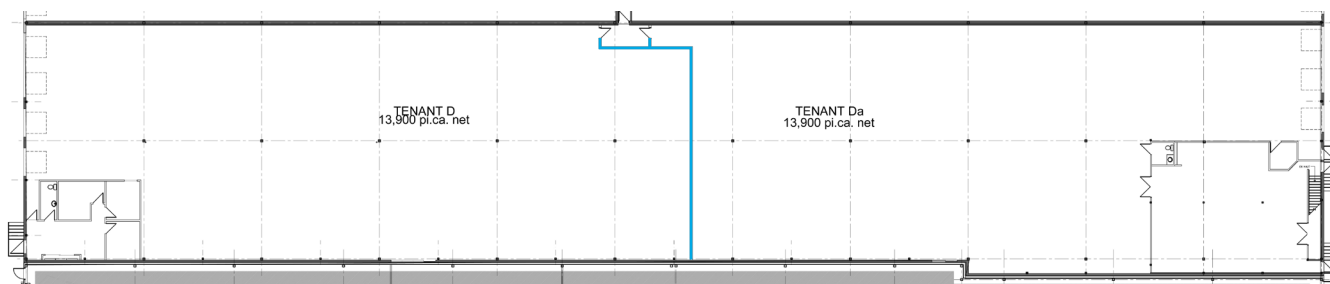

Eric Whittington

Senior Sales Representative

+1 613 683 2212

eric.whittington@colliers.com

Daniel Niedra

Associate Vice President

+1 613 683 2219

daniel.niedra@colliers.com

99 Bank Street, Suite 1005

Ottawa, ON | K1P 6B9

Main: +1 613 567 8050

collierscanada.com



This document has been prepared by Colliers for advertising and general information only. Colliers makes no guarantees, representations or warranties of any kind, expressed or implied, regarding the information including, but not limited to, warranties of content, accuracy and reliability. Any interested party should undertake their own inquiries as to the accuracy of the information. Colliers excludes unequivocally all inferred or implied terms, conditions and warranties arising out of this document and excludes all liability for loss and damages arising there from. This publication is the copyrighted property of Colliers and/or its licensors(s). © 2023. All rights reserved. This communication is not intended to cause or induce breach of an existing listing agreement. Colliers Macaulay Nicolls Inc., Brokerage.