



34 STREET

BUSINESS CENTRE

3506 78 Ave NW
Edmonton, AB
BUILDING C

For further information
visit gwlra.com or contact:

Angela Wu-Kemp BComm
Senior Leasing Manager

angela.wukemp@gwlra.com

Tel: 587.412.5580

Suite 800, 10065 Jasper Avenue
Edmonton, Alberta T5J 3B1

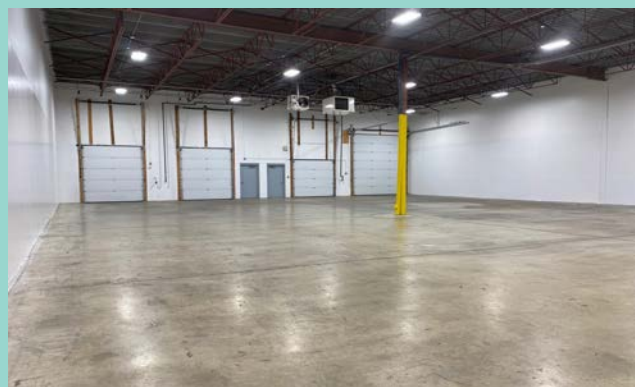

**GWL REALTY
ADVISORS**
gwlra.com

Information is subject to change. Although GWL Realty Advisors has obtained information from reliable sources, GWL Realty Advisors does not accept liability for any loss or damage suffered from reliance on this information. The subject property may be withdrawn without notice.

BUILDING C

SUITE 3506

7,233 SQ. FT.

ACCESS:

- Easy access to 34 Street, 50 Street, 76 Avenue, Sherwood Park Freeway, Whitemud Drive, and Anthony Henday Drive
- Close proximity to many amenities along 34 Street and 50 Street

ADDITIONAL FEATURES:

- Ability to accommodate dock and grade loading (metal ramp required)
- Approximately 1,200 SF office area with 3 large offices with floor to ceiling windows, kitchen area, open working space
- Energized parking stalls within the Development

SITE SPECIFICATIONS

Zoning	IB – Business Industrial	Ceiling Height	19' clear	Column Grid	30' wide x 40' deep
Heating	Overhead gas fired units (warehouse) / HVAC (office)	Power	200 Amp, 240 Volt (to be confirmed by tenant)	Warehouse Dimensions	60' x 80'
Loading	<ul style="list-style-type: none">• 3 dock loading• 12x14 overhead door (dock height with ability to ramp)	Lighting	LED Lights	Lease Rate	Market
		Sprinklers	No	Operating Costs	\$6.11 / SF (2022 Estimate)

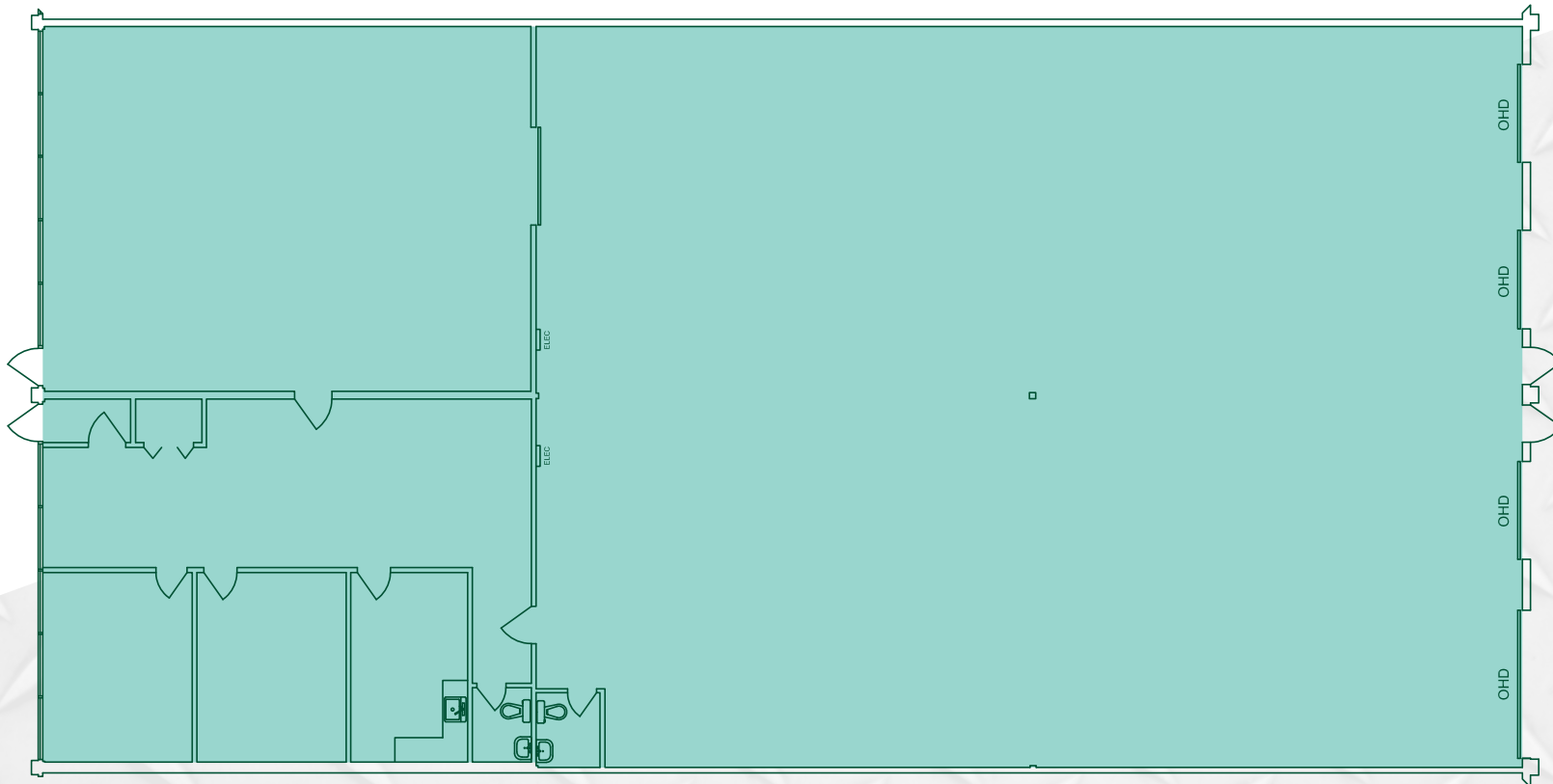

Availability:

Immediate Occupancy

BUILDING C

SUITE 3506
7,233 SQ. FT.

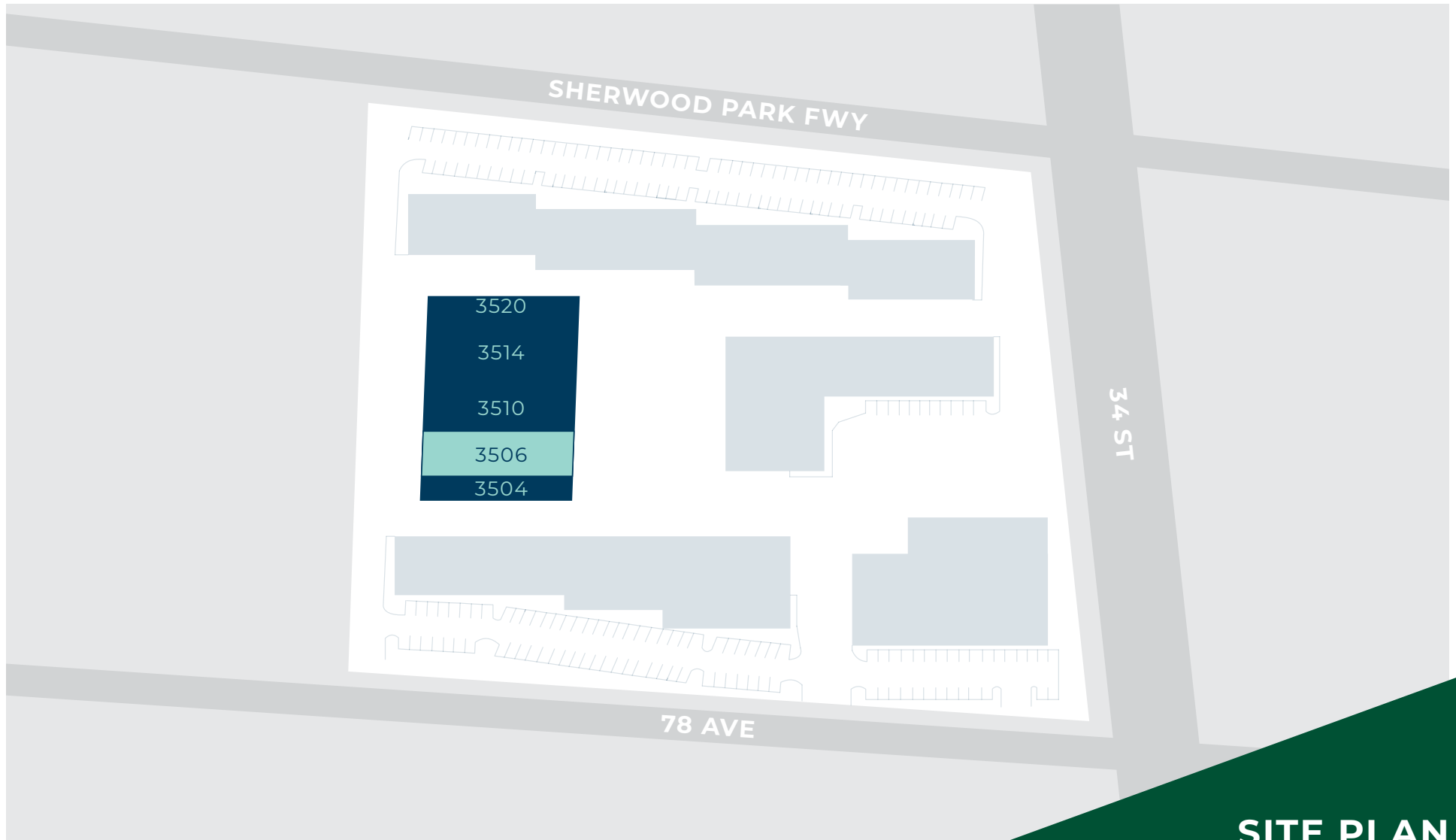

SITE PLAN

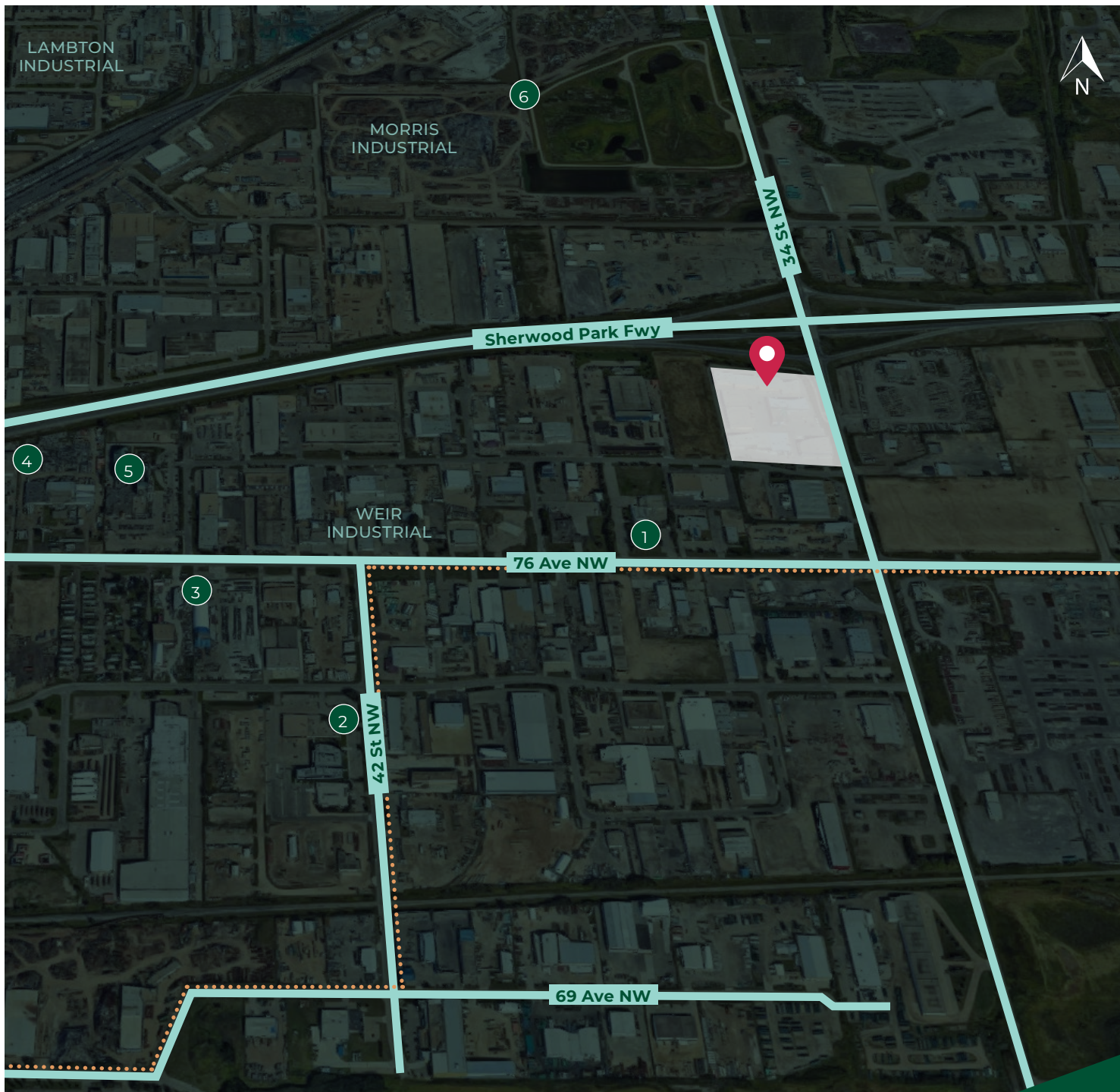

**34 STREET
BUSINESS CENTRE**

- 1 SERVICE ALBERTA BUILDING
- 2 ATCO
- 3 ALLWEST USED AUTO & TRUCK PARTS
- 4 PHOENIX INDOOR RANGE & GUN SHOP
- 5 RADISSON HOTEL & CONVENTION CENTRE
- 6 GENERAL METALS GROUP

BUS ROUTES:

..... ROUTE 83

LOCATION