

LEASED

OPPORTUNITIES

MALL COMMON AREA

GROSS LEASABLE AREAS (APPROXIMATE)			
CRU #	UNIT #	TENANT	AREA(SF)
KING GEORGE BOULEVARD, SURREY B.C.			
1	#10654	PHARMASAVE	3,554 SF
2a	#10642	PLANET FITNESS	16,433 SF
2b		LUCKY STORAGE UPPER	3,182 SF
2c		LUCKY STORAGE LOWER	13,178 SF
2d		MAIN ELEC. ROOM AND SUMPRM.	557 SF
3a	#10628	LUCKY SUPERMARKET - GROUND	26,354 SF
3b	#10628	LUCKY SUPERMARKET - UPPER	7,593 SF
6	#10612	WESTLAND INSURANCE	2,371 SF
8	#10604	DELL MECHANICAL ROOM/ADMIN	586 SF
9	#10608	OPAL DENTAL	1,564 SF
9b	#10606	BENJAMIN MOORE	1,695 SF
10	#10602	PET SOLUTIONS	5,422 SF
14	#10594	DRAKE MEDOX	1,481 SF
15	#10586	DRAKE MEDOX	706 SF
16	#10582	DRAKE MEDOX	714 SF
17	#10580	DRAKE MEDOX	711 SF
18	#10574	NDP MLA OFFICE	1,420 SF
20	#10568	DAVID NASTOH NOTARY PUBLIC	898 SF
21	#10572	MASON LOCKSMITH	1,236 SF
22	#10578	DONI RESTAURANT	856 SF
24	#10592	DONI RESTAURANT	1,398 SF
25	#10596	EASY FINANCIAL	1,536 SF
27	#10566	VACANT	2,700 SF
27	#10562	VACANT	1,631 SF
29	#10560	DOLLARAMA	9,728 SF
30	#10576	DELL LANES	13,507 SF
31	#10558	PAPA JOHN'S	1,016 SF
32	#10556	CASH MONEY	1,135 SF
33	#10560	DOLLARAMA	

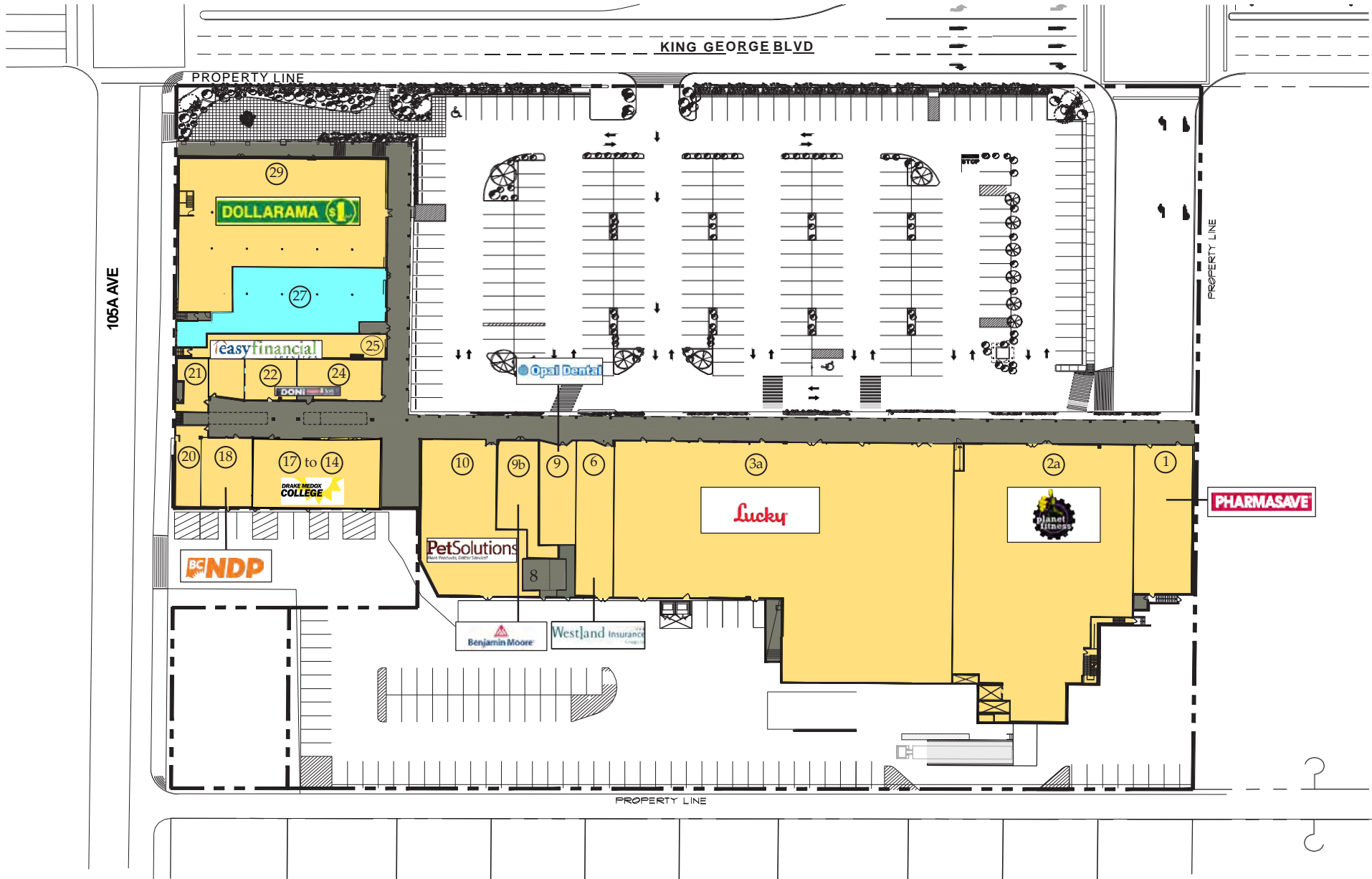

BOSA
Commercial

PROJECT NO. 3861

DELL SHOPPING CENTRE
KING GEORGE BOULEVARD, SURREY BC
FOR BOSA PROPERTIES

GROUND LEVEL LEASING PLAN
JUNE 2019

