

Retail/Office Space For Lease

BRAEMAR SQUARE

101 Avenue and 71 Street
Edmonton, Alberta



PROPERTY HIGHLIGHTS

- Easy access to/from downtown, Gretzky Drive and Sherwood Park Freeway
- Prominent exposure to 101 Avenue
- Trade area of 45,000 people
- Above average household income in trade area
- Pylon signage available
- Ample on-site storefront parking
- Professionally managed

BRAEMAR SQUARE

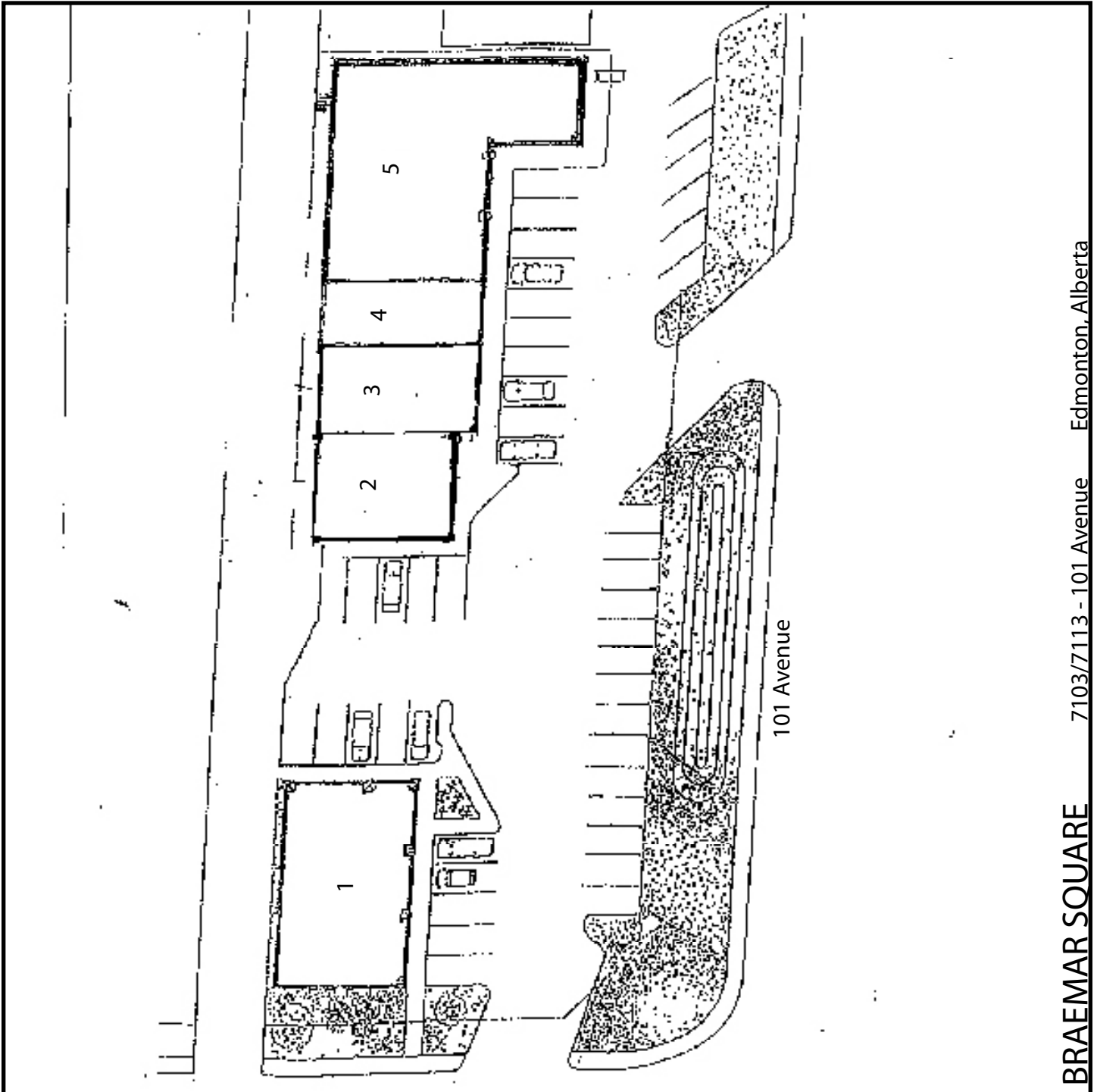

BRAEMAR SQUARE 7103/7113 - 101 Avenue Edmonton, Alberta

BRAEMAR SQUARE BUSINESSES

- | | |
|---------------------------------|-------------------|
| 1. Mac's Convenience Store | 2. Chiropractor |
| 3. Domino's Pizza | 4. Friendly Nails |
| 5. Coldwell Banker Panda Realty | |

BRAEMAR SQUARE

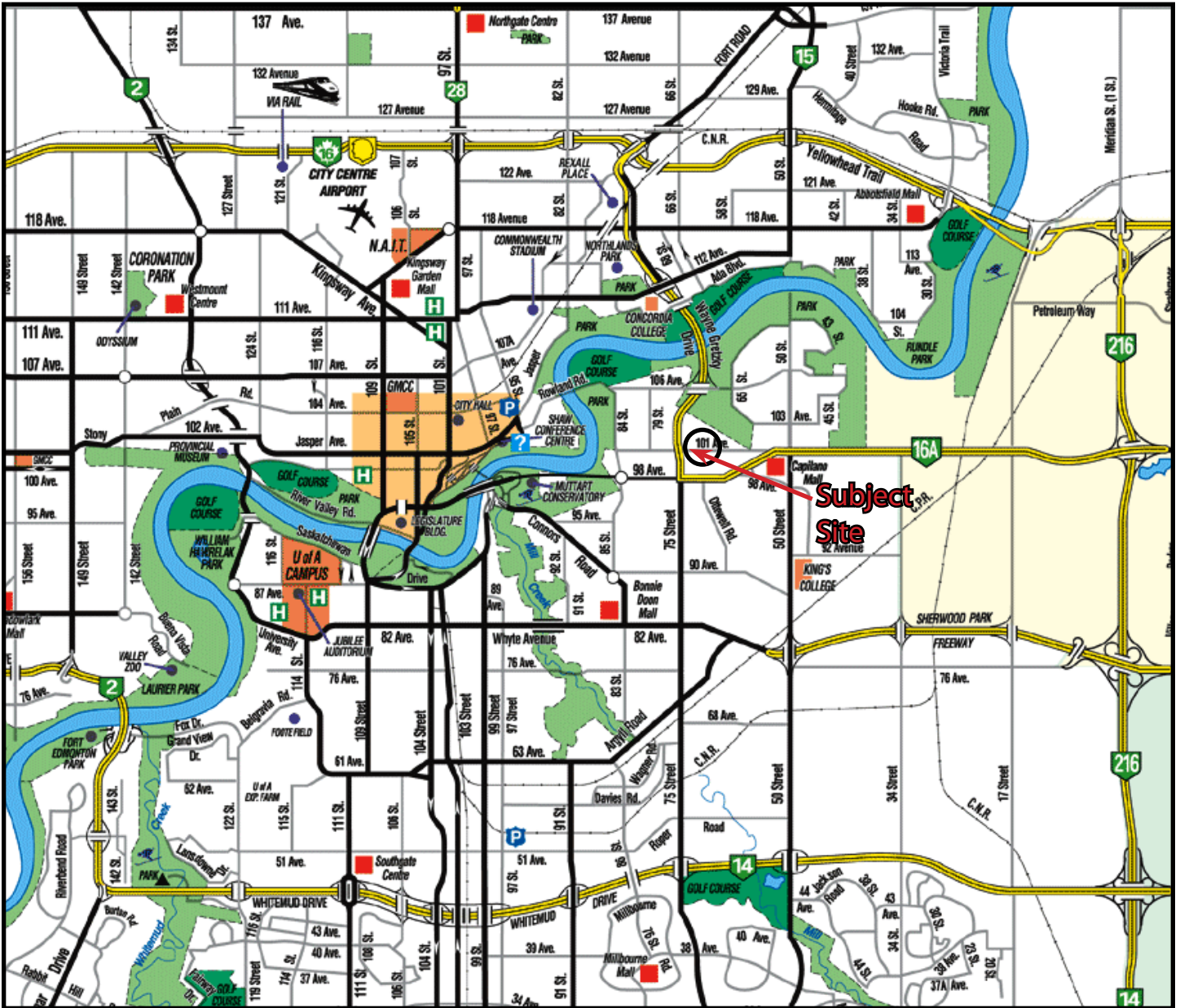

For more information please contact:

Ginny Isaac
(780) 488-2044, ext. 2234
ginny@springwood.ca

Springwood Developments Inc.
12420 - 102 Avenue
Edmonton, AB T5N 0M1

